

**PART A**

**Premises Licence**

**Peterborough City Council, Environmental Services,  
 Bridge House, Town Bridge, Peterborough, PE1 1HU**

**Premises Licence Number**

058716

**Part 1 - Premises Details**

**Postal address of premises, or if none, ordnance survey map reference or description**

Yummy Fish & Chips  
 106 Dogsthorpe Road

**Post Town** Peterborough

**Post Code** PE1 3AL

**Telephone Number** 01733 892287

**Where the licence is time limited the dates**

Start Date N/A  
 End Date N/A

**Licensable activities authorised by the licence**

**Sale by retail of alcohol**

The supply of alcohol will be for consumption off the premises.

**The times the licence authorises the carrying out of licensable activities**

**Sale by Retail of Alcohol**

Monday to Sunday Between 11.00hrs and 23.00hrs

**The opening hours of the premises**

Monday to Sunday Between 11.00hrs and 23.00hrs

**Where the licence authorises supplies of alcohol whether these are on and / or off supplies**

The supply of alcohol will be for consumption off the premises.

**Part 2**

**Name, (registered) address, telephone number and email (where relevant) of holder of premises licence**

Mr Warren Wong  
Peterborough

**Registered number of holder, for example company number, charity number (where applicable)**

N/A

**Name, address and telephone number of designated premises supervisor where the premises licence authorises the supply of alcohol**

Mrs Kin-Ling Wong  
Peterborough

**Personal licence number and issuing authority of personal licence held by designated premises supervisor where the premises licence authorises for the supply of alcohol**

|                   |                           |
|-------------------|---------------------------|
| Licence Number    | 058708                    |
| Issuing Authority | Peterborough City Council |

## **Annex 1 - Mandatory conditions**

Licensees should note that the under enclosed Mandatory conditions should be read in conjunction with the granted licence and these conditions shall be enforceable where relevant to the operation of the premise and its activities.

### **Supply of alcohol (Premises Licence)**

This registration authorises the supply of alcohol subject to the following conditions:

1. No supply of alcohol may be made at a time when
  - (a) there is no designated premises supervisor in respect of the premises licence, or
  - (b) when the designated premises supervisor does not hold a personal licence or his personal licence is suspended.
  
2. Every supply of alcohol under the premises licence must be made or authorised by a person who holds a personal licence.

## **Annex 2 - Conditions consistent with the Operating Schedule**

### **Prevention of Crime and Disorder**

3. Digital images shall be retained for a minimum of 31 days and shall be produced to an authorised officer on demand.
4. Notices advising that CCTV has been installed on the premises shall be posted up so that they are clearly visible to the public within the licensed premises.
5. An authorised person will be available at all times on the premises to show CCTV images immediately or to an authorised officer on demand.
6. CCTV images will be clear and comprehensible.
7. Alcoholic drinks shall not be consumed on the premises.

### **Public Safety**

8. A fire risk assessment required under the Regulatory Reform (Fire Safety) Order 2005 (as amended) will be completed and be available for inspection by an authorised officer.
9. Notices in relation to public health & safety will be displayed at the premises.
10. The DPS will ensure that the premises will be operated in line with The Health & Safety Act and any environmental health issues will be the responsibility of both the licence holder for the premises and the DPS.

### **Prevention of Public Nuisance**

11. The premises will only accept trade deliveries or rubbish collections during normal working hours.
12. The DPS will monitor the exterior of the premises to ensure litter is kept to a minimum.

### **The Protection of Children from Harm**

13. The DPS will be responsible for ensuring that all staff working within the premises will be fully trained and aware of the Challenge 21 rule.
14. The premises will keep a refusals register and all refusals by any member of staff shall be recorded and the record will be available for inspection upon request from an authorized officer.
15. The 'Challenge 21' initiative to prevent sales of alcohol to persons under 18 years of age will be implemented at the premises.
16. Signage will be prominently placed within the premises advertising the fact that the premises operates the 'Challenge 21' initiative.

**Annex 3 - Conditions attached after a hearing by the licensing authority**

**BLANK**

# Annex 4 – Plans

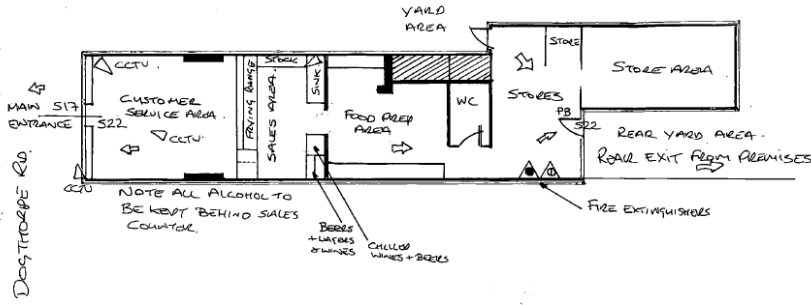

|   |                  |
|---|------------------|
| Yummy Fish & CHIPS<br>106 DOGSTHORPE ROAD<br>PETERBOROUGH<br>PE1 3AL.   |                  |
| SCALE 1:100   | CLIENT: MRS WONG |
| DATE: 16/02/2010  | DRAWN BY: D.W.C. |
| <b>FIRE EQUIPMENT</b><br>▲ CO2 FIRE EXTINGUISHER<br>▲ FOAM FIRE EXTINGUISHER<br>S22 FIRE EXIT SIGNS<br>S17 MAIN EXIT OPEN DURING TRADE HOURS<br>⇒ FIRE EXIT ROUTES. |                  |
| <b>SECURITY</b><br>▷ 3 INTERNAL CCTV CAMERAS<br>1 EXTERNAL CCTV CAMERA<br>31 DAY DIGITAL RECORDING SYSTEM.  |                  |

**PART B**

**Premises licence summary**

**Peterborough City Council, Licensing Section,  
 Bridge House, Town Bridge, Peterborough, PE1 1HU**

**Premises Licence Number**

058716

**Premises Details**

**Postal address of premises, or if none, ordnance survey map reference or description**

Yummy Fish & Chips  
 106 Dogsthorpe Road

**Post Town** Peterborough

**Post Code** PE1 3AL

**Telephone Number** 01733 892287

**Where the licence is time limited the dates**

Start Date N/A  
 End Date N/A

**Licensable activities authorised by the licence**

**Sale by retail of alcohol**

The supply of alcohol will be for consumption off the premises.

**The times the licence authorises the carrying out of licensable activities**

**Sale by Retail of Alcohol**

Monday to Sunday Between 11.00hrs and 23.00hrs

**The opening hours of the premises**

Monday to Sunday Between 11.00hrs and 23.00hrs

**Where the licence authorises supplies of alcohol whether these are on and/ or off supplies**

The supply of alcohol will be for consumption off the premises.

**Name, (registered) address of holder of premises licence**

Mr Warren Wong  
 Peterborough

**Registered number of holder, for example company number, charity number (where applicable)**

T/A

**Name of designated premises supervisor where the premises licence authorises for the supply of alcohol**

Mrs Kin-Ling Wong

**State whether access to the premises by children is restricted or prohibited**

Restricted